

# EDSYN<sup>INC</sup>®

## 981C-230

### LONER<sup>®</sup>

## Temperature Controlled Soldering Station

- COMPLIES WITH MIL-S-45743E, MIL-STD-2000-1B, WS6536E AND ESD SPEC, DOD-STD-1686, DOD-HDBK-263



**Instruction manual**

# EDSYN<sup>INC</sup>®



Static Safe



Temp. Regulation Indicator



Digital Panel Meter



Temp. Control Knob



Sponge Holder



24V

PD528 Tool Pod



Power Switch

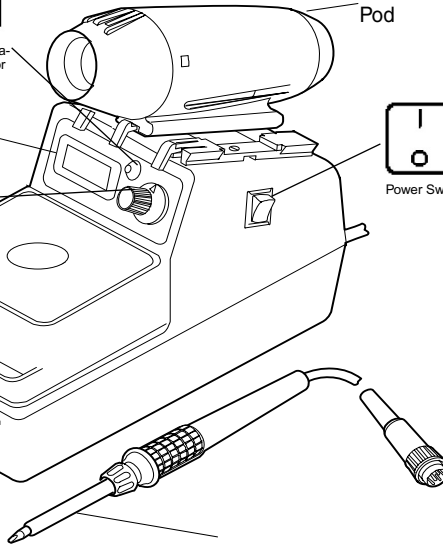

Direct Tip-Heater Configuration

## WARNING:

**DO NOT HIT OR TAP THE SOLDERING TOOL. THE HEATER ELEMENT WILL BREAK!!!**

## DISTINGUISHING FEATURES

### Power Cord

For 981C-230

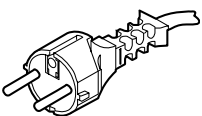

For 981C-230B

13A Fuse inside

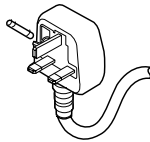

For 981C-230I

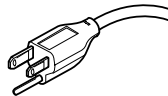

For 981C-230P

POWER CORD WIRING

BROWN to LINE

BLUE to NEUTRAL

GRN/YEL to GROUND



## SPECIFICATIONS

- 230V, 50 Hz, 2.5 lbs. (1.13 kg.)
- 24V, 30W Heater rating
- COMPLIES WITH DOD-STD-2000-1B, MIL-STD-2000A and ESD SPEC. DOD-STD 1868, DOD-HDBK-263
- TEMP. RANGE: 400°F - 800°F (205°C - 427°C)
- TEMP. REGULATION: ±6°F (±3°C)

# REPLACING TIPS

## CHANGING TIP for 981

1. MAKE SURE YOUR TOOL IS COOL!
2. Turn Retaining Sleeve counter-clockwise to remove.
3. Remove old Soldering Tip.
4. Insert new Tip.
5. Install Retaining Sleeve.

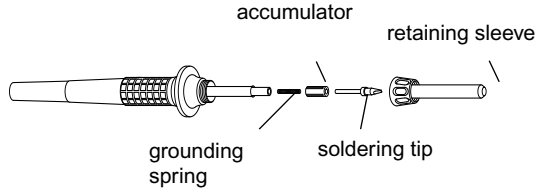

## General Purpose Soldering Tips

Iron Plated for long life-Nickel and Chrome Plated for optimum heat transfer.

EDSYN has over a 100 varieties of standard and custom-made Tips. CONTACT EDSYN FOR MORE SELECTIONS.



	Part No. & Description	a	b
	LT374 Standard Probe	.03 (0.8 mm)	.48 (12.2 mm)
	LT375 Standard Spade	.06 (1.5 mm)	.48 (12.2 mm)
	LT376-7 SMD Channel	.12 (3.0 mm)	.48 (12.2 mm)
	LT392 Extra-Long Needle	.02 (0.5 mm)	1.13 (28.8 mm)
	LT394 Extra-Long Spade	.07 (2.0 mm)	.93 (23.6 mm)
	LT399 Large Face	.17 (4.3 mm)	.49 (12.4 mm)
	LT444 SMD Mid-Length Fine Spade	.04 (1.0 mm)	.78 (19.8 mm)
	LT446 SMD Probe	.03 (0.8 mm)	.48 (12.2 mm)
	LT382 Long Cone	.02 (0.5 mm)	.62 (15.6 mm)
	LT395 Mid-Length Stubby Spade	.09 (2.3 mm)	.74 (18.8 mm)
	LT431 Mid-Length Spade	.07 (1.8 mm)	.74 (18.8 mm)
	LT439 SMD Thin Probe	.03 (0.8 mm)	.50 (12.7 mm)
	LT439-1 Same as LT439, Angled		
	LT445 SMD Angle Face	.03 (0.8 mm)	.48 (12.2 mm)

## CALIBRATION SET-UP USING MS412

1. Install desired Soldering Tip.
2. Turn on power and set Temperature Control Knob to 400°F (205°C).
2. Apply a small amount of solder on the Tip, just enough to form a bead on top of the Tip.
3. Place the center of the thermocouple wire of the SDS100 on top of the bead.
4. Again, apply a small amount of solder on the center of the thermocouple wire, just enough to embed the center.

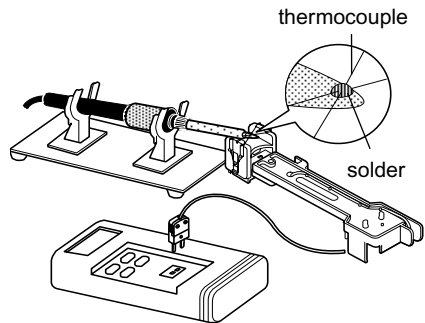

## TEMPERATURE CALIBRATION

AIR MOVEMENT WILL AFFECT THE TEMPERATURE READING. WORK IN AN AREA WHERE THERE IS MINIMUM AIR MOVEMENT.

1. Do "calibration set-up using MS412" procedure (above)
2. Set Temp. Control Knob to MIN.
3. Adjust LO Tip Temp. Cal. Pot so the Digital Panel Meter will read 385°F (196°C).
4. Set Temp. Control Knob to MAX.
5. Adjust HI Tip Temp. Cal. Pot so the Digital Panel Meter will read 825°F (441°C).
6. Set Temp. Control Knob to MIN.
7. Adjust LO Digital Panel Meter Cal. Pot so the Digital Panel Meter will read 385°F (196°C)
8. Set Temp. Control Knob to MAX
9. Adjust HI Digital Panel Meter Cal. Pot so the Digital Panel Meter will read 825°F (441°C)

HI Digital Panel Meter Cal. Pot

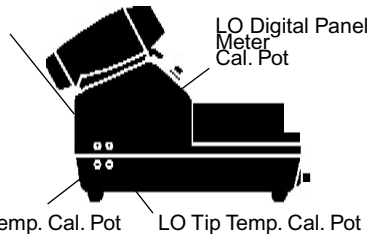

# 981C-230 instruction manual

## MAINTENANCE

### • Replace RS199 Cleaning Sponge

1. Fill water only up to the top of the RS243 Leveling Pad.
2. Depress RS199 to moisten it completely.

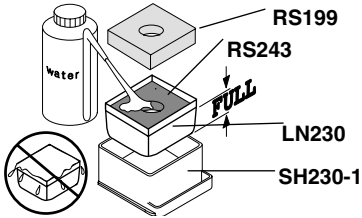

### • Replace SC581 Solder Collector

1. Hold the Housing firm and turn Cap counter-clockwise and pull it away from the Housing.
2. Remove used SC581 and replace with a new one.
3. Reassemble Pod with TOP of the Cap in proper position.

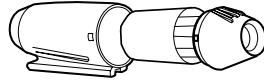

**SR042**  
Thermal  
Housing

**SC581**  
Solder Col-  
lector

**SR043**  
Front Hous-  
ing

### CAUTION:

Over-filling can cause thermal shock to the tip or heating element during tip cleaning.

ALL RIGHTS RESERVED.

NO PART OF THIS PUBLICATION INCLUDING THE INDIVIDUAL ICONS MAY BE REPRODUCED OR UTILIZED IN ANY FORM OR BY ANY MEANS WITHOUT THE PERMISSION OF EDSYN, INC.

THE NAMES LONER, SOLDAPULLT, SOLDVAC, ATMOSCOPE AUTO-VAC, IDLE-REST, PIXTER, FUMINATOR, OCTAVAC AND KLATCH ARE REGISTERED TRADEMARKS OF EDSYN, INC.



Intellectual  
Property

MOST PRODUCTS ARE COVERED BY U.S. AND FOREIGN PATENTS AND PENDING APPLICATIONS.

DESIGN, COLOR AND MATERIALS  
SUBJECT TO CHANGE WITHOUT NOTICE.

TIP STYLE ON SOLDERING, DESOLDERING AND HOT AIR TOOLS MAY VARY.

PRINTED IN U.S.A.



**EDSYN** INC<sup>®</sup>

...the power of precision

15958 Arminta Street • Van Nuys • CA 91406-1896  
Web Site [www.edsyn.com](http://www.edsyn.com) • eMail [info@edsyn.com](mailto:info@edsyn.com)