

EDSYN^{INC}®

ZD500HA-3-230 *SOLDAPULLT*®

ATMOSCOPE® and LONER®
Hot Tip Desoldering Hot Air
and Soldering Rework Station

(self-contained)

- COMPLIES WITH MIL-S-45743E, MIL-STD-2000, DOD-STD-2000-1B, WS6536E AND ESD SPEC, DOD-STD-1686, DOD-

MADE
IN
U.S.A.



instruction brochure

ZD500HA-3-230

SOLDAPULLT[®]

ATMOSCOPE[®] and LONER[®]

Self-Contained Hot Tip Desoldering Hot Air and Soldering Rework Station.

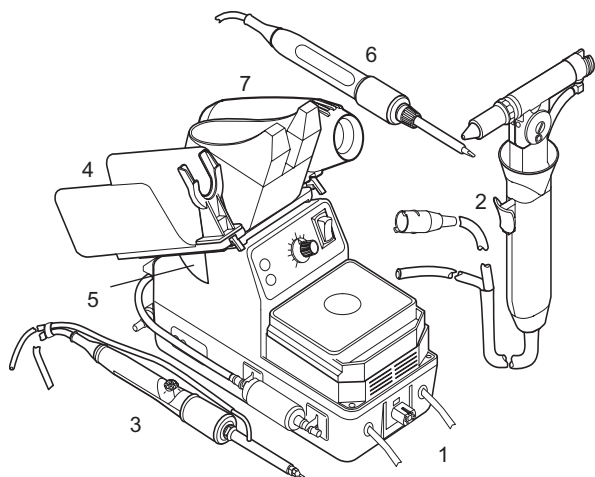

ASSEMBLY

1. PS501-230I Power Supply
2. HT500 Hot Tip Desoldering Tool
3. FA493I Hot Air Tool
4. PD525 Tool Holder for Hot Air PD529 shown
5. PA233-1 Dovetail Extension
6. CL1580I Soldering Iron
7. PD528 Tool Pod

Components needed to expand a PS501 (power supply for ZD500DX) to a Hot air Station.

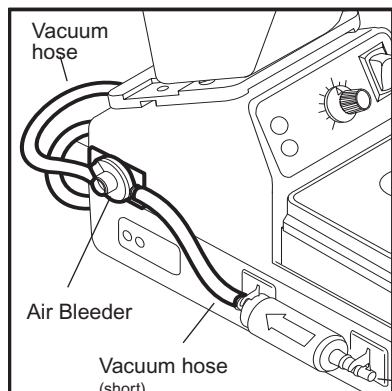

Connect to desoldering tool

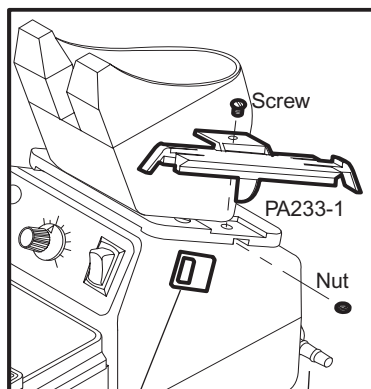

Install wrench holder at an angle

Connect to hot air tool

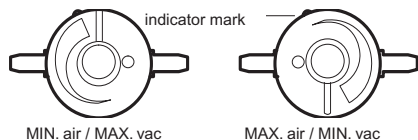

FEATURES

POWER SUPPLY



Static Safe

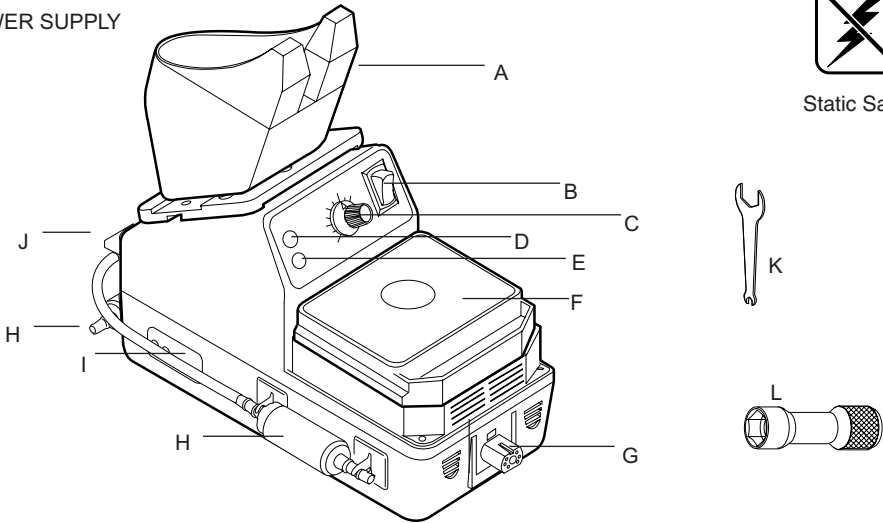

- A) Tool Pod, equipped with micro-switch to activate pump.

B) Power Switch, to activate WorkStation.

C) Temp. Control Knob

D) Pump LED

E) Heater LED

F) SH232 Sponge Holder, with cleaning sponge.
- G) Power Output Connector, 24V, controlled (for ZD500DX-230, see below)

H) AF110 Filter, (note flow direction)

I) Calibration Pot

J) Pump

K) WT623 Tip Wrench

L) WT619 Tip Wrench

DISTINGUISHING FEATURES

Power Cord

For ZD500DX-230	For ZD500DX-230B 3A Fuse inside	For ZD500DX-230I	For ZD500DX-230P POWER CORD WIRING BROWN to LINE BLUE to NEUTRAL GRN/YEL to GROUND

Power Output Connector

For ZD500DX-230 For ZD500DX-230I		For ZD500DX-230B For ZD500DX-230P	
-------------------------------------	--	--------------------------------------	--

SPONGE MAINTENANCE

Replace RS199 Cleaning Sponge
Pour water on RS199 to moisten it completely.
DO NOT OVERFILL.

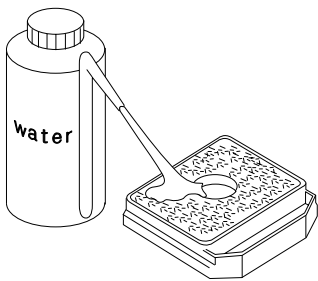

FILTER MAINTENANCE

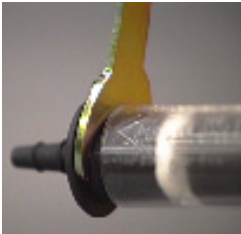

Filters should be kept clean

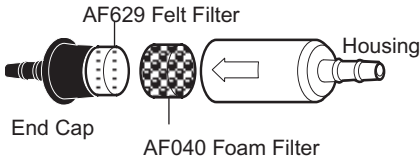

Tip Wrench can be use
to remove filter cap.

AIR FLOW DIREC-

Hoses must be clean and not
kinked or cracked

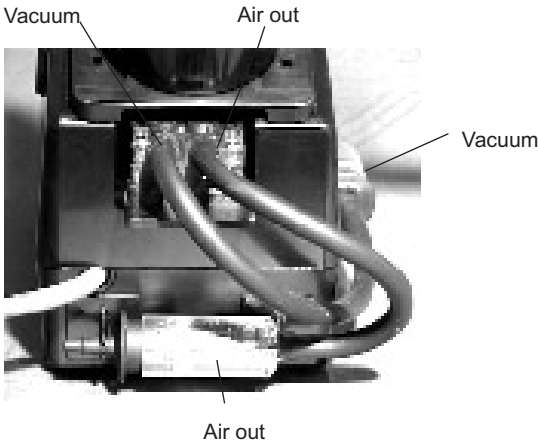

SPECIFICATIONS

- 230V, 50/60 Hz, 133W - 340W
- Weight; **Power Supply:** 5 lbs. 12 ozs. (2.6 kg)
Hand Tool: 11 ozs. (312 g)
- Temperature range of 400°F to 800°F (205°C-425°C)
- Voltage leakage from tip to ground, less than 2 MV
- Tip to ground resistance, less than 2 ohms
- COMPLIES WITH MIL-S-45743E, DOD-STD-2000-1B, WS-6536E and ESD SPEC, DOD-STD-1686, DOD-HDBK-263

HT500 *SOLDAPULLT*[®]

Hot Tip Desoldering Tool

POWER REQUIREMENTS:

- 24V
- VACUUM SOURCE



ESD Safe

- A) Head Assembly- Includes the primary filtering system and solder debri chamber.
- B) Hot Tip Desoldering Tip- Wide range of desoldering Tips applicable.
- C) Head Shaft- Allows 4-point rotation of Head Assembly.
- D) Trigger- Activates vacuum suction.
- E) Vacuum Hose- Low Static silicone hose. Connects to vacuum source.
- F) Connector- To 24 V controlled output.
- G) Cleaning Shaft- For cleaning Desoldering Tip orifice: .05 (1.3 mm) and .025 (0.6 mm)

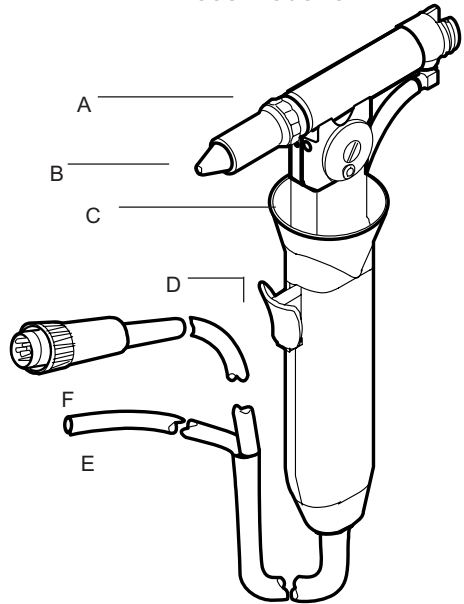

SPECIFICATIONS

- 24V, 50/60 Hz, 70W
- Weight: 11 ozs. (312 g)
- Temperature range of 400°F to 800°F (205°C-425°C)
- Voltage leakage from tip to ground, less than 2 MV
- Tip to ground resistance, less than 2 ohms
- COMPLIES WITH MIL-S-45743E, DOD-STD-2000-1B, WS-6536E and ESD SPEC, DOD-STD-1686, DOD-HDBK-263
- UL Listed

ADJUSTMENTS

The HT500 Head assembly can be adjusted into varying positions to suit the operator.

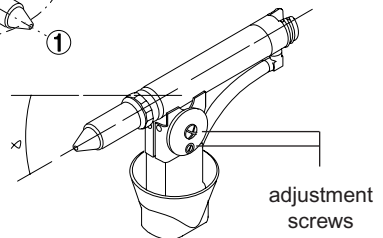
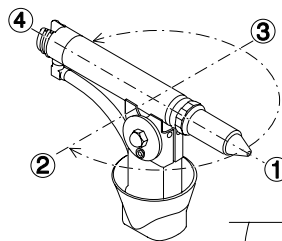

While Tool is in the Pod, push handle down and twist handle until it locks into 1 of it's 4 positions. Twisting counter-clockwise will permit a 180° turn. Twisting clockwise will permit a 90° turn.

Note: Head Assembly does not make a full 360° turn

To tilt the Head assembly, loosen (2) Adjustment Screws. Tilt the Head assembly to desired position. Retighten Screws.

OPERATION

- 1. Connect HT500 to 24V power supply and vacuum source.
- 2. Press trigger to activate vacuum.
- 3. Always clean the Tip with wet sponge and always re-tin (add fresh solder) during and after each operation.

NOTE: When Tip orifice is blocked, use a correct size Cleaning Shaft while pressing the Trigger to clear the obstruction.

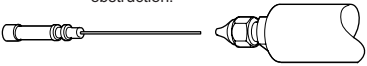

CS468 is .05 in. dia.
CS468-1 is .025 in. dia.

DESOLDERING POINTERS

- 1. When desoldering small holes on flat areas, tilt Tool to allow adequate air flow to lift solder into chamber.

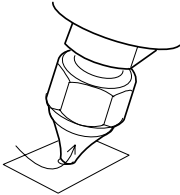

- 2. When using SMD Tips, heat up the connections by positioning the Tool perpendicularly. When solder melts tilt the Tool and depress trigger. (SMD Tips are recommended for HT500 using external vacuum).

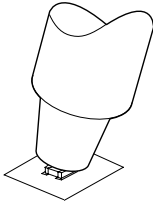

- 3. Extra-heavy duty desoldering on a multi-layered board is done by using a Heavy Duty Desoldering Tip and a Hi-Heat Soldering Tip simultaneously. Although pre-heating of the circuit board will speed up the process, it is not always necessary.

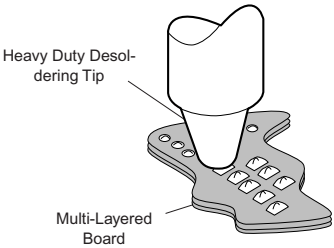

REPLACING DESOLDERING TIPS

- 1. Remove RS383. Use WT619.
- 2. Replace Tip and install new Tip.

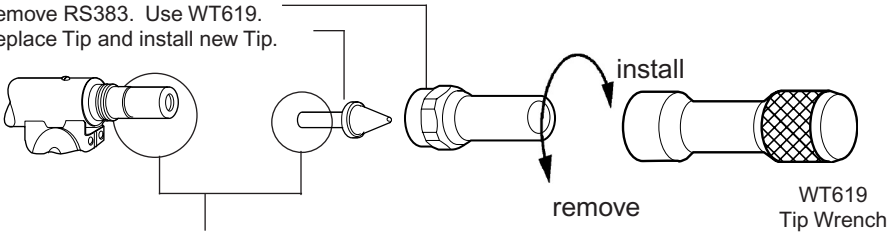

- 3. Apply AN112 (in tube) or AN122 (in syringe) Anti-Seize Compound before assembling.
INSPECT DAILY
- 4. Install RS383.

Hot Tip Desoldering Tips

Fractional dimensions are approx.

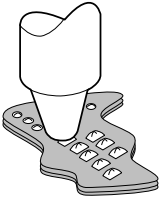

Extra-heavy duty desoldering on a multi-layered board is done by using a Medium Life Desoldering Tip.

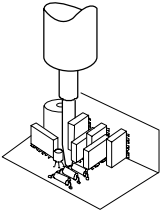

To reach deep, dense and compact areas, use a Long Funnel Tip

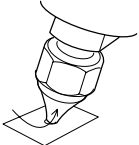

When using a Replacement Desoldering Tip to desolder small holes on flat areas, tilt Tool to allow adequate air flow to lift solder into chamber.

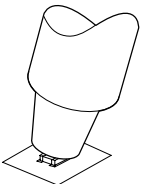

When using SMD Tips, heat up the connections by positioning the Tool perpendicularly. When solder melts, tilt the Tool and depress trigger.

DESCRIPTION	PART NO.	HOLE DIAMETER			B		
		in.	in.	mm	in.	in.	mm
Medium Life (High Heat Transfer) 	ZD12	.03	1/32	0.8	.50	1/2	12.7
	ZD13	.04	3/64	1.0			
	ZD14	.06	1/16	1.5			
	ZD18	.07	5/16	1.8			
	ZD19	.12	1/8	3.2			
Long Life (Low Heat Transfer) 	ZD08	.03	1/32	0.8	.44	7/16	11.8
	ZD10	.04	3/64	1.0			
	ZD11	.06	1/16	1.5			
Funnel 	ZD107	.02	1/64	0.5	.48	31/64	12.2
	ZD112	.03	1/32	0.8			
	ZD113	.04	3/64	1.0			
Long Funnel 	ZD111	.03	1/32	.08	1.22	17/32	31
Replacement* 	ZD25	.03	1/32	0.8	.39	32/64	9.9
	ZD26	.04	3/64	1.0			
	ZD27	.07	5/16	1.7			
SMD** (FOR ZD505/905 series) 	ZD57	.10	7/64	2.5	.55	9/16	13.9
	ZD58	.13	1/8	3.2			
	ZD60	.15	5/32	3.8			
	ZD61	.25	1/4	4.5			

Hot Tip Desoldering Tip

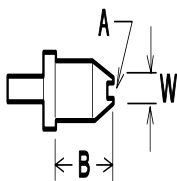

Surface Sweep Tips removes excess solder on pads for flatter surface, prior to SMD remounting.

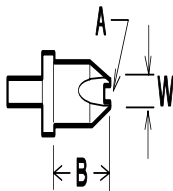

Side Sweep Tips allows removal of solder from the component side of the board.

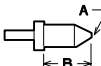
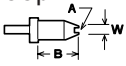
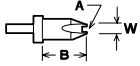
DESCRIPTION	PART NO.	HOLE DIAMETER			B					
		in.	in.	mm	in.	in.	mm			
Economy** 	ZD28	.03	1/32	.08	.30	5/16	7.6			
	ZD29	.04	3/64	1.0						
	ZD30	.06	1/16	1.5						
Surface Sweep** 	ZD70	W								
		in.	in.	mm						
		Hole Dia. = .06 in.								
Side Sweep** 	ZD71	.08	3/32	2.0						
Hole Dia. = .06 in.										

*Tin New Iron Tips at Low Temperature before using.

**Non-Plated Alloy

Hot Tip set-up

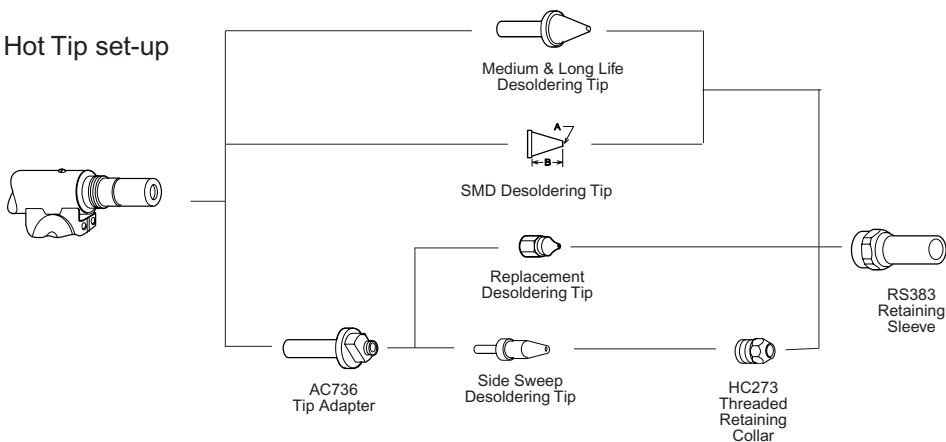

Heater Set-up

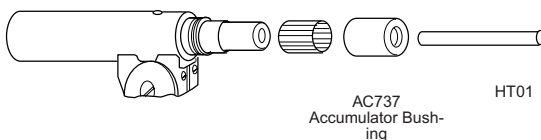

DAILY MAINTENANCE

- Remove and inspect Tip and Heater Assy.
- Inspect all Filters
- Remove solder debri from Desoldering Head Housing

WEEKLY MAINTENANCE

- Inspect Valve Assy.
- Inspect all O-Rings and Seals

TO REPLACE FILTER & O-RING INSIDE DESOLDERING HEAD ASSY.

1. Pull out FC639 from Housing.
2. Unscrew SC525 from FC639 to remove AF625.
3. Insert new AF625 inside SC525 and screw back on.
4. Clean and apply OL111 on OS731 & OS132 O-Ring.

Ⓒ - Clean

Ⓓ - Replace

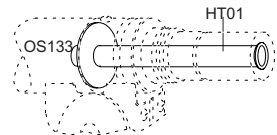
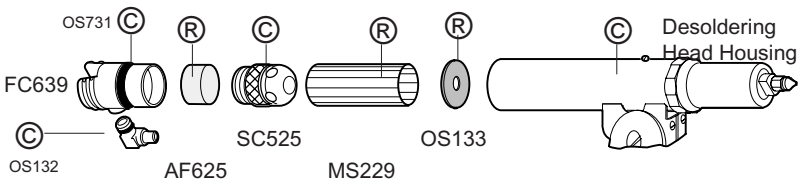

When installing OS133, the HT01 should go thru the OS133.

TO REPLACE O- RINGS INSIDE VALVE ASSEMBLY

- a) Unscrew Lock Nut at the end of the HT500 Handle.
- b) Remove Handle Cover.
- c) Slide out Valve Assembly while placing your finger over the Spring Seat. BE CAREFUL NOT TO LET THE SPRING AND THE SPRING SEAT SHOOT OUT FROM THE HOUSING
- d) Clean all parts with alcohol only.
- e) Replace OS730 O-Ring Set (set of 3).
- f) Lube new O-rings with OL111 O-Ring Lube.

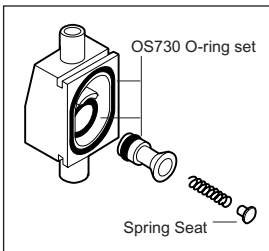
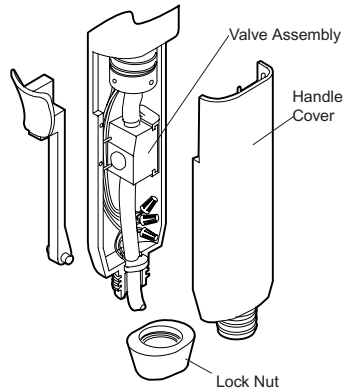

CAUTION: Make sure the wires are not pinched by Valve Assembly.

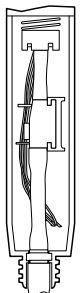

HT500/-1 **SOLDAPULLT** HOT TIP
 DESOLDERING TOOL
 SPARE PARTS LIST

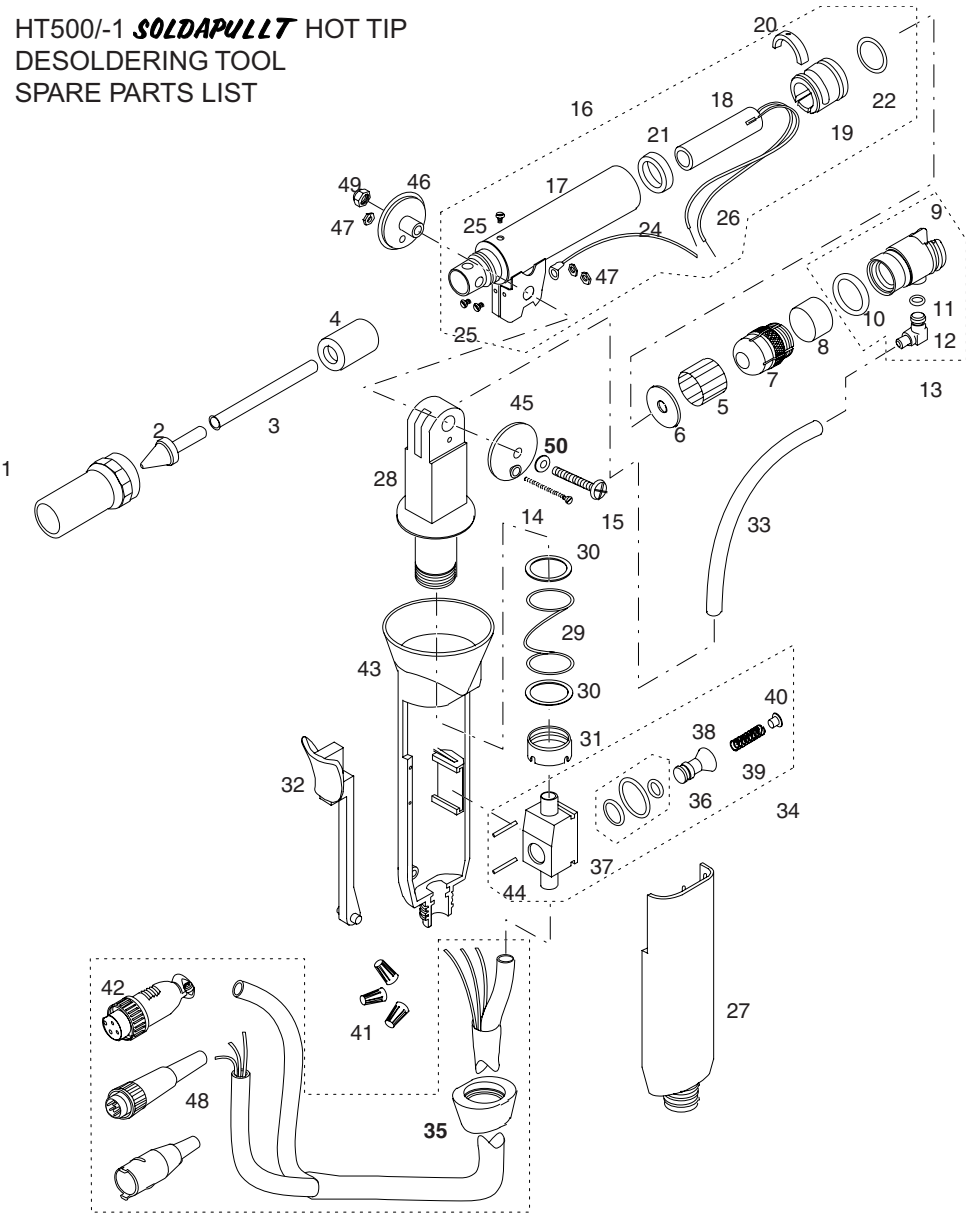

ITEM NO.	PART NO.	DESCRIPTION	QTY REQ'D
1	RS383	Retaining Sleeve	1
2	ZD13	Hot Tip Desoldering Tip	1
3	HT01	Hot Tube	1
4	AC737	Accumulator Bushing	1
5	MS229	Mica Sheet	1
6	OS133	Silicone Washer	1
7	SC525	Solder Cone	1

ITEM NO.	PART NO.	DESCRIPTION	QTY REQ'D
8	AF625	Felt Filter	1
9	SR148	Housing for End Cap 1	
10	OS731	O-Ring for End Cap	1
11	OS132	O-Ring for End Cap Elbow Connector	1
12	SR147	Connector for End Cap	1
13	FC639	End Cap	1
14	SR008	Flat Head Slotted Screw for Index Flange	1
15	SR168	Pan Head Phillip Screw for adjusting Desoldering Head Assy.	1
16	HT500H	Desoldering Head Assembly- Repairable by EDSYN Customer Service Dept.	1
17	SR136	Desoldering Head Housing	1
18	SR120	Heater Element	1
19	SR117	Heater Element Bushing (O-Ring included)	1
20	SR118	Retaining Key for Heater Element Bushing	1
21	SR119	Teflon Spacer for Heater Element	1
22	OS731	O-Ring for Heater Bushing	1
24	SR121	Grounding Wire	1
25	SR122	Screw, 2-56 x 1/8 Pan Head Slotted	3
26	SR145	Sleeving, Braided Fiberglass	2
27	SR004	Handle Cover	1
28	SR124	Head Shaft	1
29	SR125	Spring for Head Shaft	1
30	SR126	Washer, Nylon	2
31	SR127	Retaining Nut for Head Shaft	1
32	SR128	Trigger	1
33	HL603	Hose, Low Static Silicone, 3/16" I.D.	5"
34	SR335	Valve Assy.	1
35	SR393	Nut, Retaining, for Handle	1
36	OS730	O-Ring Set (Three O-Rings)	1 set
37	SR129	Valve Housing	1
38	SR130	Poppet (O-Ring Included)	1
39	SR131	Return Spring for Poppet	1
40	SR132	Seat for Return Spring	1
41	SR133	Wire Nuts	3
42		SR134 Hose and Wiring Assembly for HT500	1
		SR565 for HT500-1 SR635 for HT500-2	
43	SR123	Handle Base	1
44	SR143	Wire Guide, Nylon, 3/8" Length	2
45	SR005	Index Flange (Screw Side)	1
46	SR006	Index Flange (Nut Side)	1
47	SR007	Nut, Hex, 2-56 thread	3
48		SR135 Connector for HT500	1
		SR353 for HT500-1 SR633 for HT500-2	
49	SR170	Cap Nut, Hex #8-32 x 5/16"	1
50	SR169	Washer, Flat, 1/16" thick	1

POWER SUPPLY
SPARE PARTS VIEW

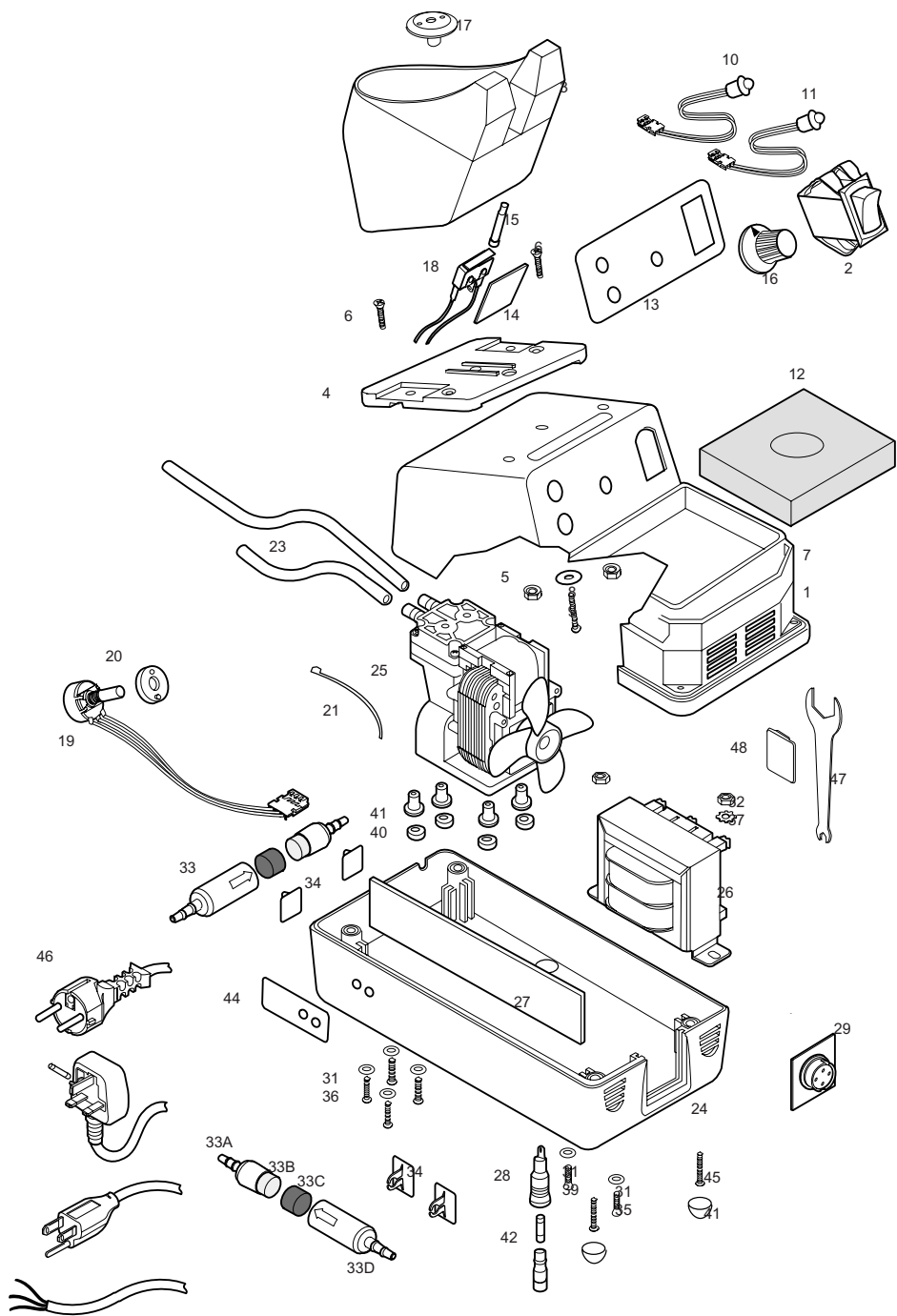

TROUBLE SHOOTING

Problems that occur aside from those listed below should be handled by our factory technicians.

Symptoms	Cause	Remedy
Pump won't run	a) Pump micro switch is stuck. b) Vacuum inside hose (normal)	a) Use a pair of tweezers to release the switch. b) Squeeze trigger to release vacuum.
Pump running but weak or no vacuum generated.	a) Loose connections between joints or connectors. b) Dirty filters. c) Leaky or sticky valve. d) Wrong hose connection. e) Broken pump diaphragm.	a) Make sure all connections are tight. b) Inspect and clean all filters. Replace elements if needed. c) Clean parts and replace O-Rings if needed . d) HT500 Hose should be connected to AF110. e) Ship back to factory
No power	Blown fuse	Replace fuse. See spare parts list

For Factory repair:
Specify the problem and ship the unit to EDSYN INC.
Customer Service
15958 Arminta Street
Van Nuys, CA 91406-1896

ZD500DX-230 Spare Parts List

See next page for illustration

ITEM NO.	PART NO.	DESCRIPTION	QTY REQ'D
41	SR470	Well Nuts, for Pump Mounting	4
42	SR249	Fuse, 1.6A	1
43	SR310	Label, Calibration, Left Rear	1
44	SR011	Screw, Round Head Phillips, 6-18 x 5/8	4
45	SR251	Bump-Ons	4
46A	SR318	Power Cord Only, (european plug)	1
46B	SR454	Power Cord Only, (british plug)	1
46C	SR026	Power Cord Only, (NEMA plug)	1
46D	SR163	Power Cord Only, (no plug)	1
47	WT623	Tip Wrench, Dual Open End, 1/4" & 3/4"	1
48	SR416	Holder, Tip Wrench Hanger	1

ITEM NO.	PART NO.	DESCRIPTION	QTY REQ'D
1	SR566	Top Cover, Power Supply	1
2	SR452	Power Switch, 230V	1
3	SR073	Tool Holder	1
4	SR035	Adapter plate	1
5	SR467	Nut, Square Cone	3
6	SR367	Screw, Flat Head Phillips, 6-32 x 5/8	2
7	SH232	Sponge Holder	1
8	SR137	Washer, #8	1
9	SR009	Screw, Pan Head Slotted, 8-32 x 7/8	1
10	SR865	LED Assy. Yellow, for pump	1
11	SR573	LED Assy. Green	1
12	RS199	Cleaning Sponge	1
13	SR567	Label, Front Panel	1
14	SR115	Retainer Plate for Micro Switch	1
15	SR114	Push Rod for Micro Switch	1
16	SR045	Knob, Temperature Control	1
17	SR112	Flange, Retainer for Tool Pod	1
18	SR568	Micro Switch Assy.	1
19	SR243	Potentiometer Assy.	1
20	SR255	Spacer, for Potentiometer Assy.	1
21	SR050	Cable Tie	1
23	HS307	Hose, Low Static Silicone, 3/8 ID. (sold per foot)	2@
		7" and 10"	
24	SR484	Bottom Base	1
25	SR491	Pump / Motor Assy, 230V	1
26	SR539	Transformer, Dual Primary, 24V output	1
27	15242W70	Circuit Board	1
28	SR569	Fuse Holder, Panel Mount	1
29A	SR570	Connector Assembly (ZD500DX-230 only)	1
29B	SR711	Connector Assembly (ZD500DX-230B/I/P)	
31	SR016	Washer, #6	6
32	SR017	Nut, 6-32	3
33	AF110	Filter, In-Line Vacuum	2
33A*	SR266	End Cap	2
33B*	AF629	Felt Filter	2
33C*	AF040	Foam Filter	2
33D*	SR533	Barrel, Clear, for AF110	2
34	SR439	Holder, Clip	4
35	SR561	Screw, Round Head Phillips, 6-32 x 3/4	1
36	SR468	Screw, Round head Phillips, 6-32 x 7/8	4
37	SR139	Washer, Star	4
39	SR144	Screw, Round Head Slotted, 6-32 x 1/2	1
40	SR469	Spacer, for Pump Mounting	4

*To order a complete filter assembly, ask for AF110

CALIBRATION (for ZD500DX, 505, 905 series only)

AIR MOVEMENT WILL AFFECT THE TEMPERATURE READING.

WORK IN AN AREA WHERE THIS IS MINIMAL.

1. Using a clean Tip, turn on power and set Temperature Control Knob to approx. 500°F (260°C). Allow Tip to warm up.
2. Tin the tip properly and place center of the thermo-couple wire on tip.
3. Apply a small amount of solder on the center of the thermo-couple wire, to form a good contact between the tip and the thermo-couple wire.
4. Set Temperature Control Knob to 400°F (205°C).
5. Adjust LO-Temp. Calibration Pot so the Meter will read 400°F (205°C).
6. Set Temperature Control Knob to 800°F (427°C).
7. Adjust HI-Temp. Calibration Pot so the Meter will read 800°F (427°C).

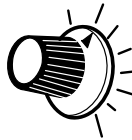

Temperature Control Knob



Calibration Pot

TEMPERATURE CALIBRATION

AIR MOVEMENT WILL AFFECT THE TEMPERATURE READING.

WORK IN AN AREA WHERE THIS IS MINIMUM.

1. Use the DS299S to remove the temperature control knob. Turn Temp. Control (A) so arrow points to cord.
2. Use the SRW01 to pull out heater assembly, PCB & power cord from handle. Leave enough power cord slack to install SRF30.

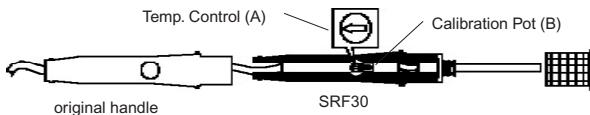

3. Place heater assembly, PCB & power cord inside SRF30. Install tip that is clean and well tinned.
4. With the use of the MS412 Temperature Calibration System. Follow set-up shown below.
5. Plug in tool and by using the Pot Adjustment Tool supplied, turn Temp. Control (A) to "solder-melt" temperature.
6. Apply a small amount of solder on the Tip, just enough to form a solder bead on top of the Tip. Place the center of the thermocouple wire of the on top of the solder bead.
7. Again, apply a small amount of solder on the center of the cross wire, just enough to embed the center.
8. Turn Temp. Control (A) fully clockwise. Adjust Calibration Pot (B) until reading stabilizes at 800°F.
9. Assemble unit in original handle.
10. Before installing the Temp. Control Knob, peel-off pointer label from the Knob.
11. Using same MS412 set-up, install and adjust Temp. Control Knob so Meter will read desired temperature.
12. Attach new pointer label in accordance with the reading of the Meter.

EDSYN^{INC}®

CL1580I LONER®

Temperature Controlled
SOLDERING INSTRUMENT



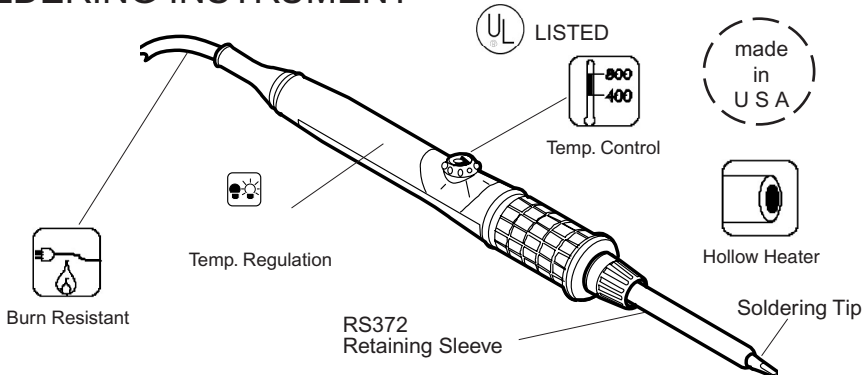



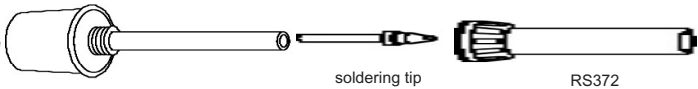

- 230V, 50/60Hz, 70W, 5 Oz (142 gm)
- TEMP. RANGE: 400°F - 800°F (205°C - 427°C)
- TEMP. REGULATION: $\pm 6^{\circ}\text{F}$ ($\pm 3^{\circ}\text{C}$)
- TIP TO GROUND LEAKAGE: $< 2\text{MV}$
- TIP TO GROUND RESISTANCE: $< 2\text{ OHMS}$
- COMPLIES WITH DOD-STD-2000-1B, MIL-STD-2000A and ESD SPEC. DOD-STD 1868, DOD-HDBK-263

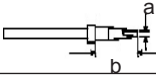
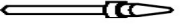

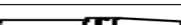
CHANGING TIP

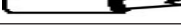
1. MAKE SURE YOUR TOOL IS COOL!
2. Turn RS372 counter-clockwise to remove.
3. Remove old Soldering Tip.
4. Insert new Tip.
5. Install RS372. (should be "finger" tight only.)

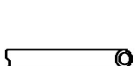
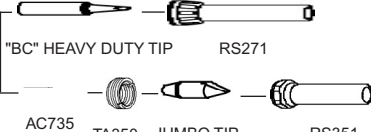

SOLDERING TIPS					
Iron Plated for long life•Nickel and Chrome Plated for optimum heat transfer					
CONTACT EDSYN FOR MORE SELECTIONS					
				a	b
	LT374	Standard Probe		.03 (0.8 mm)	.48 (12.2 mm)
	LT375	Standard Spade		.06 (1.5 mm)	.48 (12.2 mm)
	LT392	Extra-Long Needle Point		.02 (0.5 mm)	1.13 (28.8 mm)
	LT394	Extra-Long Spade		.07 (2.0 mm)	.93 (23.6 mm)
	LT446	SMD Probe		.03 (0.8 mm)	.48 (12.2 mm)
	LT37BC	Heavy Duty Terminal Spade		.10 (2.5 mm)	.74 (18.8 mm)
	LT223BC	Heavy Duty Fine Spade		.06 (1.5 mm)	1.21 (30.7 mm)
	LT222BC	Extra long Needle Point		.04 (1.0 mm)	1.21 (30.7 mm)
	LT153BH	Jumbo Spade		.20 (4.9 mm)	.93 (23.6 mm)
	LT155BH	Jumbo Angle Spade		.32 (8.3 mm)	.97 (21.1 mm)
SET-UP & REQUIRED ACCESSORIES FOR HEAVY DUTY AND JUMBO					
Apply AN112 or AN122* Anti-Seize Compound to Heater and area of Tip contact.					
					
*AN122 Anti-Seize Compound comes in syringe dispenser.					
					



Fine point tip for SMD soldering.

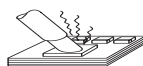

Large and heavy tip for heavy duty soldering.

CL1580I LONER® Soldering Instrument Spare Parts List

Disassembly of this Tool will require the use of SRW01 Heater Removal Tool.

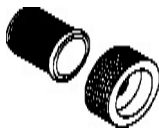

ITEM NO.	PART NO.	DESCRIPTION	QTY
1	LT375	LONER® Standard Spade Soldering Tip	1
2	RS372	Retaining Sleeve Assembly (RS382 & RB386)	1
2a	RS382	Retaining Sleeve	1
2b	RB386	Retaining Bushing	1
3	SR076	230 V Hollow Heater Assembly	1
4	SR081	Vinyl Finger Grip for Retaining Collar.	1
5	RC334	Threaded Retaining Collar for Heater Assy.	1
6	SR028	Power Cord,	1
7	SR029	Boot for Power Cord	1
8	SR030	Clear Handle for Model 930	1
9	SR031	Knob, Temperature Control for Clear Handle	1
10	SR111	Logo, Pointer, 3/8" Dia. Self Adhesive	1
11	SR032	Cord Strain Relief	1
12	SR105	Circuit Board, Model 930	1

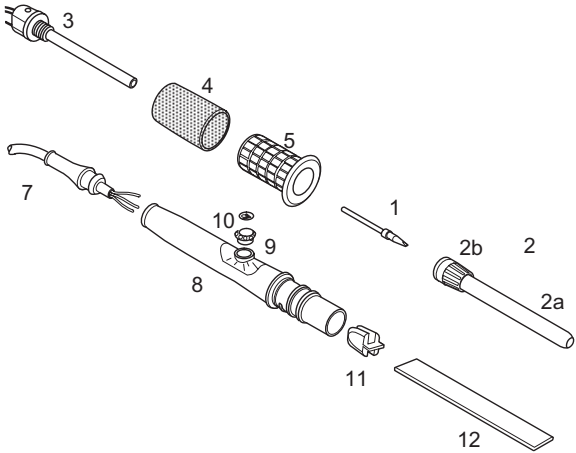

TIP CLEANING To maintain proper Tip to Ground resistance.

1. Remove Tip from Heater Assembly.
2. Using a ST707 Soldering Tool Maintenance Brush, clean Tip and Heater Barrel at surface shown.

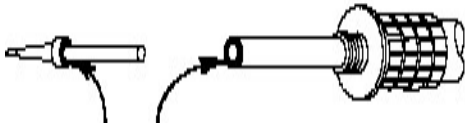

clean these areas

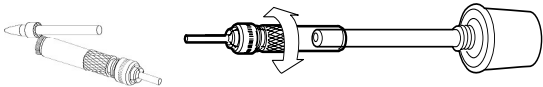

3. Install the tip and tighten RS372 Retaining Sleeve. Take note of the gap to ensure proper

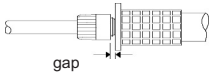

If there is no gap, try replacing the RS372 Retaining Sleeve.



EDSYN^{INC}®

FA493I ATMOSCOPE[®] SMD Hot Air Tool

OPERATING REQUIREMENTS:

- 230V, 50/60 Hz
- Regulated air flow

**CAUTION: HOT AIR WILL BURN
!!! Turn off air and place tool in Pod
when not in use**

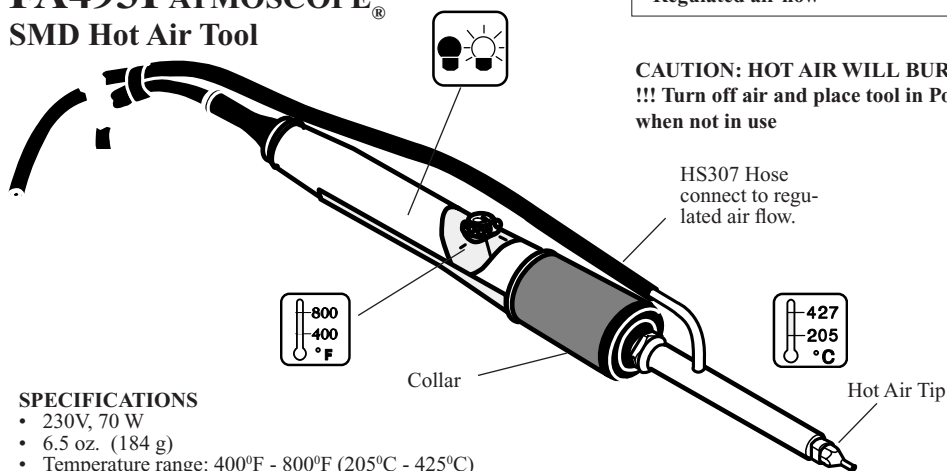

SPECIFICATIONS

- 230V, 70 W
- 6.5 oz. (184 g)
- Temperature range: 400°F - 800°F (205°C - 425°C)
- Temperature regulation: $\pm 6^\circ\text{F}$ ($\pm 3^\circ\text{C}$)
- Voltage leakage from tip to ground less than 2 MV
- Tip to ground resistance less than 2 ohm
- Complies with MIL-S-45743E, DOD-STD-2000-1B, MIL-STD-2000 WS6536E and ESD SPEC, DOD-STD-1686, DOD-HDBK-263.

OPERATION

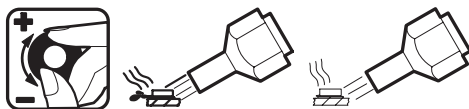

The 3 very important factors involved when working with the ATMOSCOPE SMD Hot Air Tool are **amount of air output, temperature setting and type of Tip used**. The key to an effective soldering is to reflow the solder **without blowing the solder** across the board and thus creating bridges.

1. Have the proper Tip installed.
2. Connect Hose to regulated air source.
3. Plugged-in Tool to a power source and set desired temperature.
4. Turn on the air and adjust pressure .
5. Direct hot air towards the connection until solder melts. Using "SMD helpers" will make your job easier.

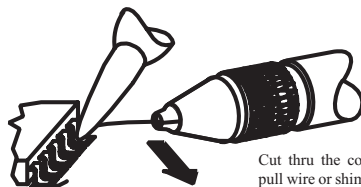

Cut thru the connection with a pull wire or shim blade while hot air melts the solder.

CHANGING TIPS Efficiency is greatly dependent on choosing the proper tip to meet each application.

1. Turn Tip counter-clockwise by using a **WT618** Tip Wrench. (set of 2, the other is to hold the **RS321** Retaining Sleeve) or use a **WT620**.
2. Remove and replace with desired Tip.

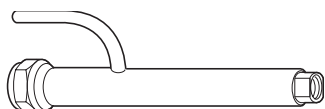
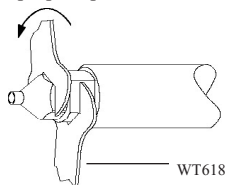

Hot Air Tip



WT620

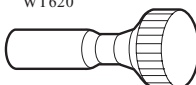

FA493I ATMOSCOPE® SMD HOT AIR TOOL **SPARE PARTS LIST**

ITEM NO	PART NO.	DESCRIPTION	QTY REQ'D
1	HS307	Hose, Low Static Silicone (Sold Per Foot)	5 ft.
2	SR072	230 V Hollow Heater Assembly for FA493I	1
3	SR081	Vinyl Finger Grip	1
4	RC349	Threaded Retaining Collar	1
5	OS139	O-Ring, Silicone, for FA069 (Set of 2)	1 set
6	CC355	Chamber Coil for FA069 Hot Air Tool	1
7	RS321	Retaining Sleeve for FA069 Hot Air Tool	1
9	LT428	LONER® S.M.D. Hot Air Turbo Flow Tip	1
10	SR028	Power Cord, 3-Prong, 120 VAC	1
11	SR029	Boot for Power Cord	1
12	SR030	Clear Handle for Model 930	1
13	SR031	Knob, Temperature Control for Clear Handle	1
14	SR111	Logo, 3/8" Dia. Aluminum, Self Adhesive	1
15	SR032	Cord Strain Relief	1
16	SR105	Circuit Board, Model 930, 230V	1
17	CA165	Clip, for 1/4 in. Hose (set of 5)	1

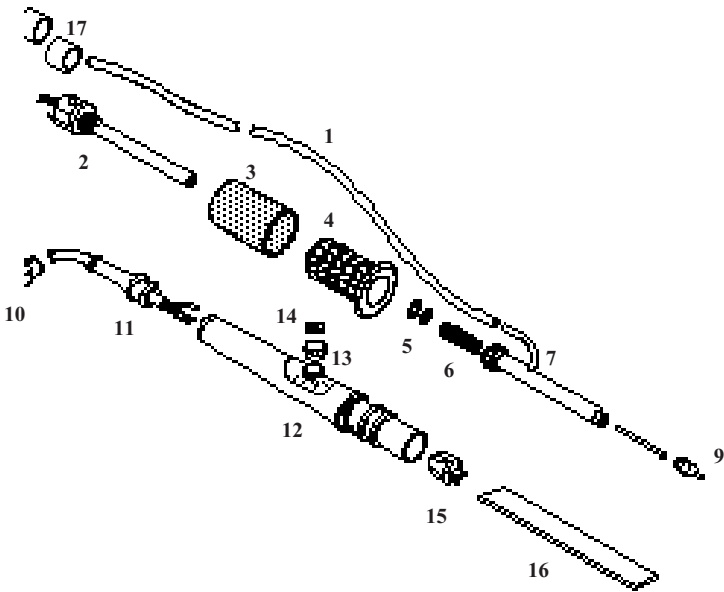

ZD500HA-3-230 instruction brochure



ALL RIGHTS RESERVED.

NO PART OF THIS PUBLICATION INCLUDING THE INDIVIDUAL ICONS
MAY BE REPRODUCED OR UTILIZED IN ANY FORM OR BY ANY MEANS
WITHOUT THE PERMISSION OF EDSYN, INC.

THE NAMES LONER, SOLDAPULLT, SOLDAVAC, ATMOSCOPE
AUTO-VAC, IDLE-REST, OCTAVAC AND KLATCH
ARE REGISTERED TRADEMARKS OF EDSYN, INC.



Intellectual
Property

MOST PRODUCTS ARE COVERED BY U.S. AND
FOREIGN PATENTS AND PENDING APPLICATIONS.

DESIGN, COLOR AND MATERIALS
SUBJECT TO CHANGE WITHOUT NOTICE.

TIP STYLE ON SOLDERING, DESOLDERING AND HOT AIR TOOLS MAY VARY.

PRINTED IN U.S.A.



15958 Arminta Street • Van Nuys • CA 91406-1896
Web Site www.edsyn.com • eMail info@edsyn.com